

DETAIL PLAN OF STAIRCASE AT MUMTY FLOOR
SCALE:- 1:50

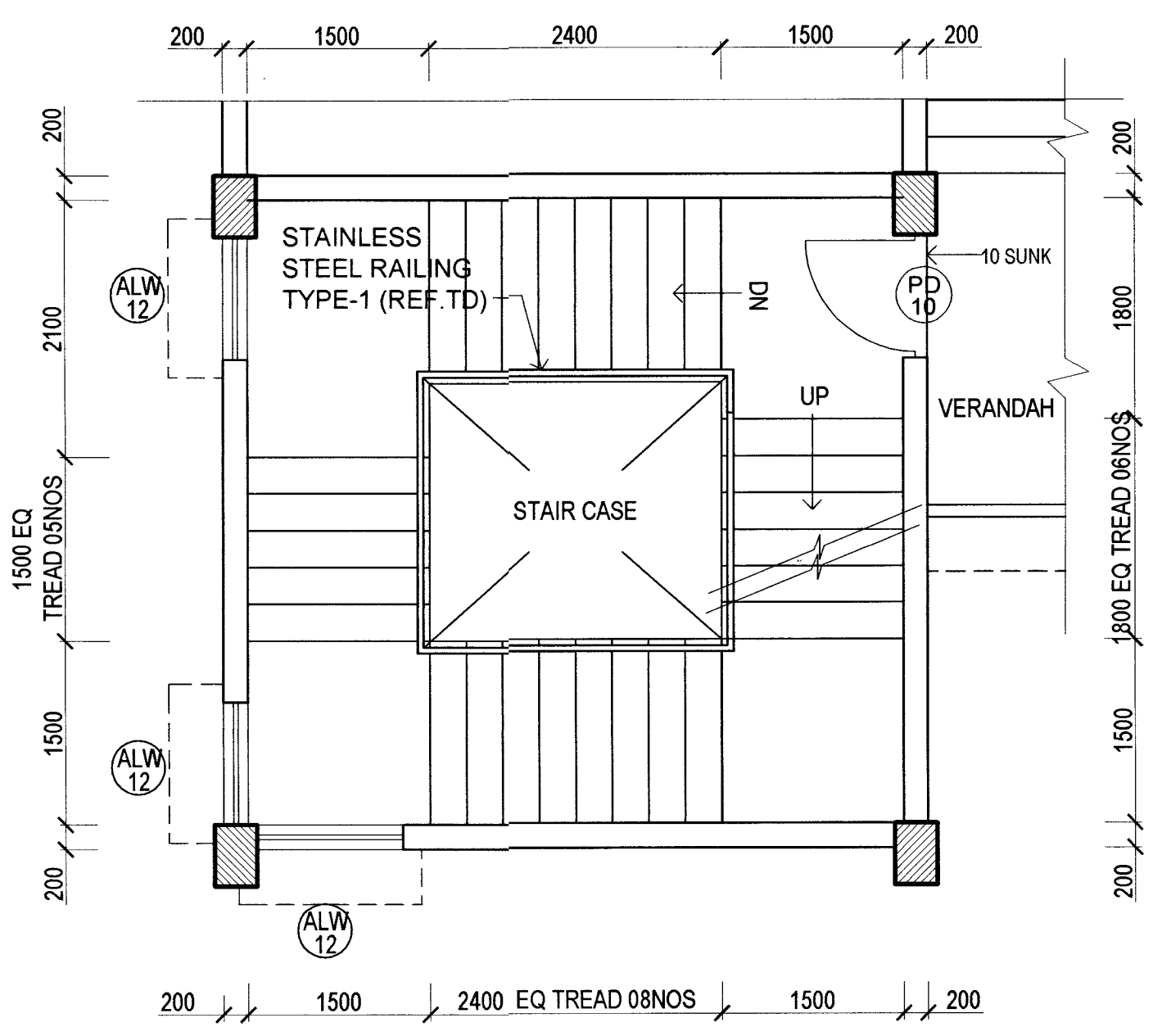

DETAIL PLAN OF STAIRCASE AT FIRST FLOOR
SCALE:- 1:50

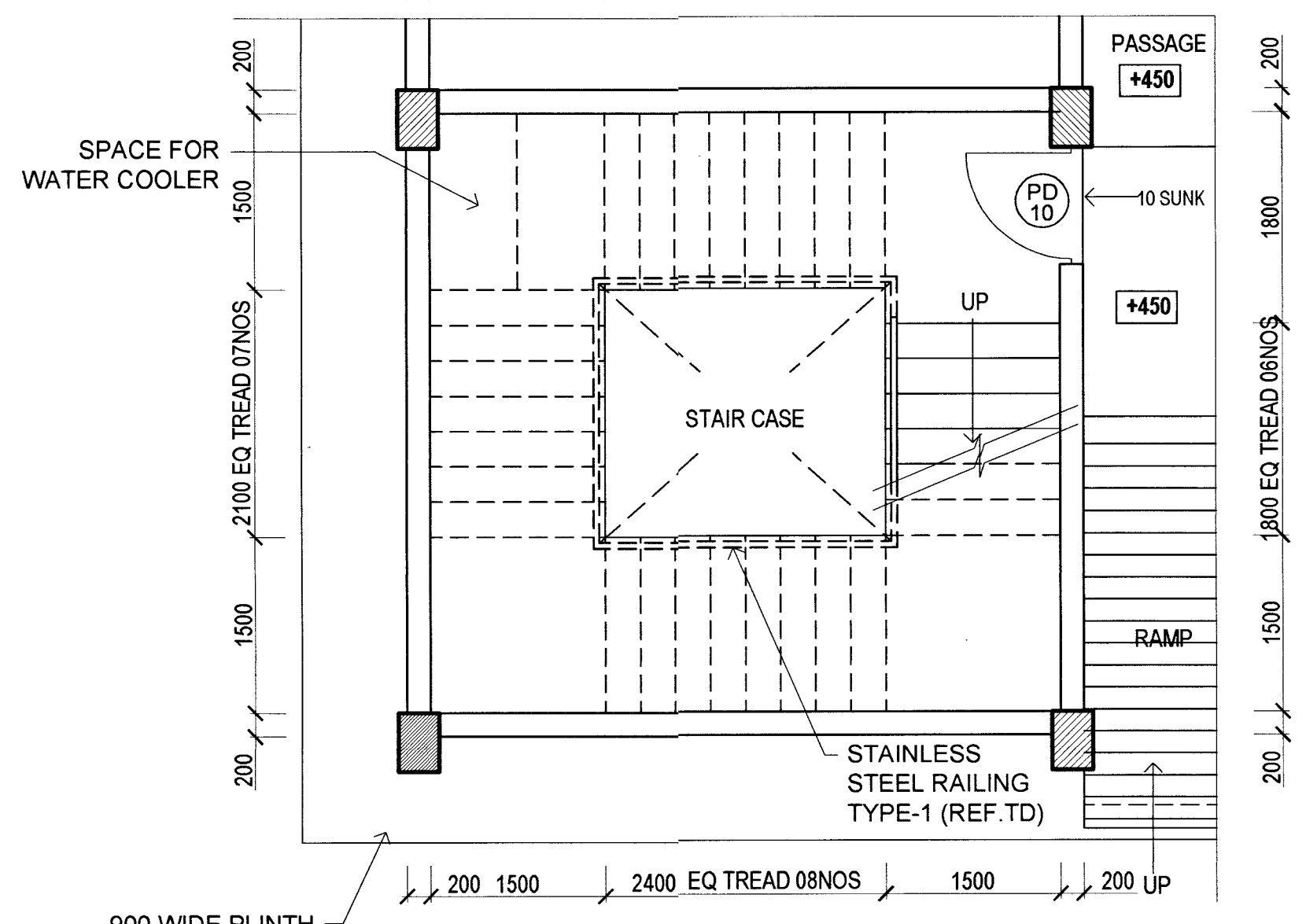

DETAIL PLAN OF STAIRCASE AT GROUND FLOOR
SCALE:- 1:50

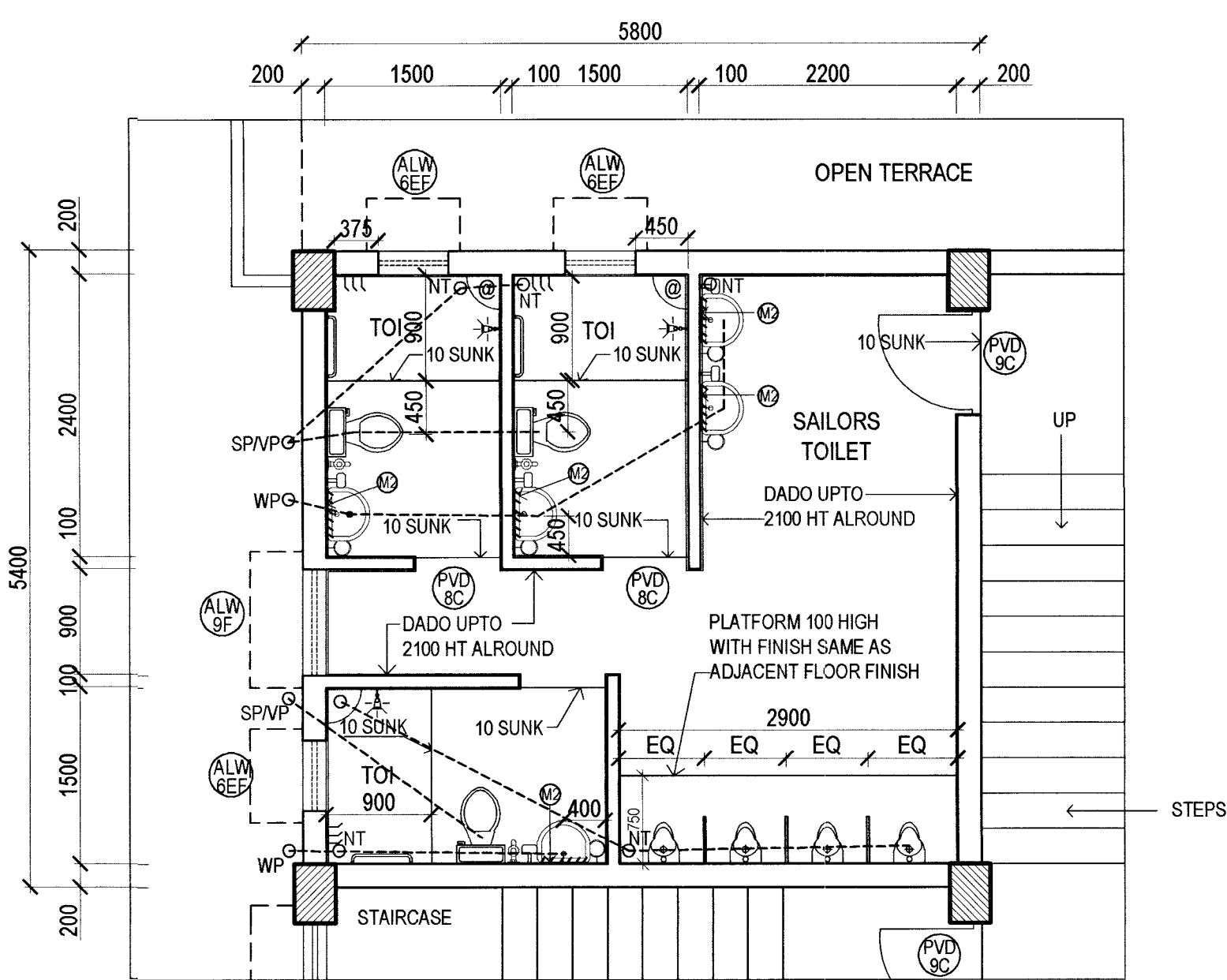

DEAIL PLAN OF SAILORS TOILET
AT FIRST FLOOR PLAN
SCALE:- 1:50

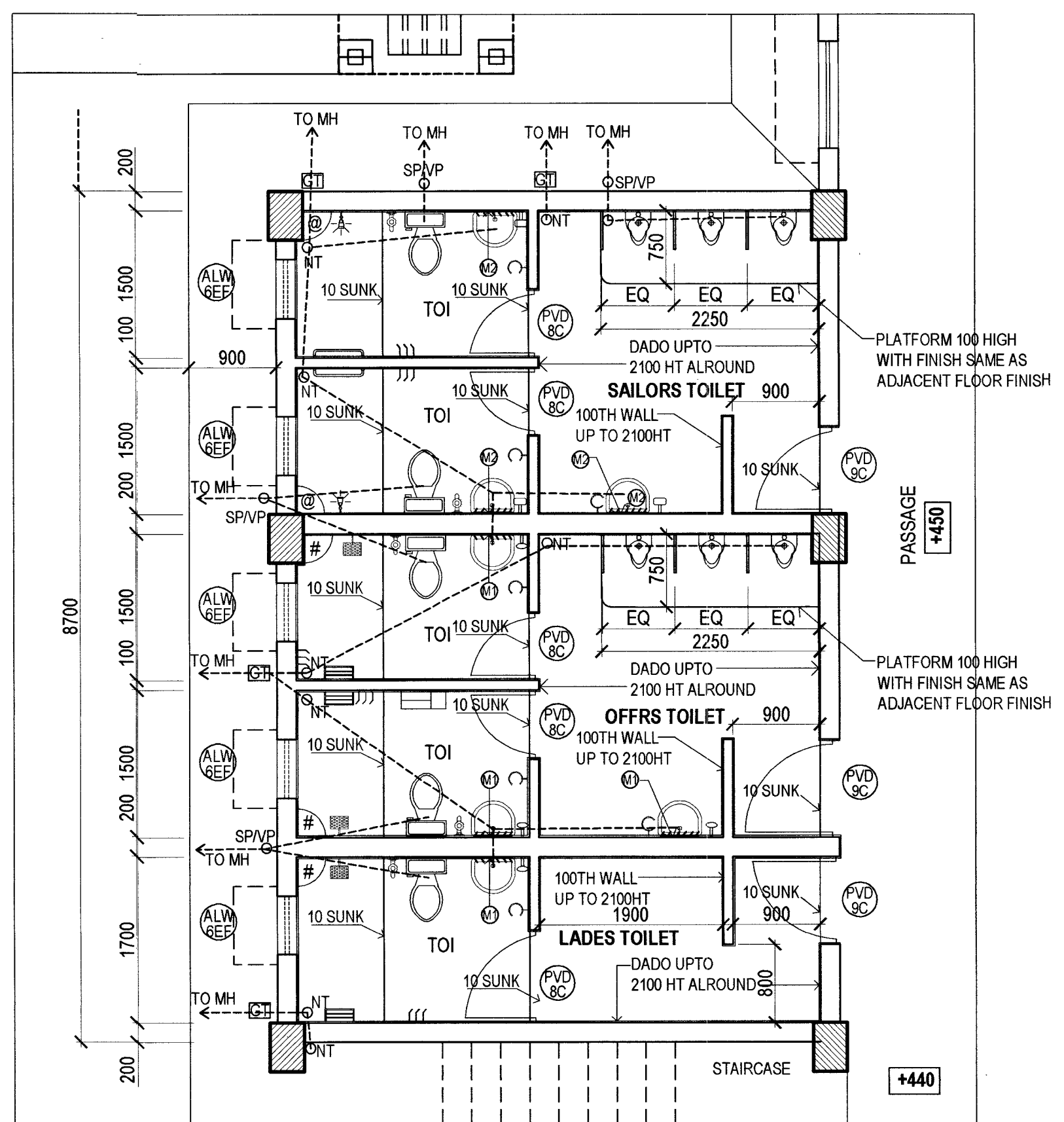

DETAIL PLAN OF LADIES,OFFRS AND SAILORS TOILET
AT GROUND FLOOR
SCALE:- 1:50

LEGEND AND SCHEDULE OF TOILET FITTINGS AND FIXTURES

| SL NO. | DESCRIPTION | SIZE (MM) | SHOWN THUS | LADIES TOILET | OFFICER'S TOILET | SAILOR'S TOILET (GF) | SAILOR'S TOILET (FF) |
|--------|--|---|------------|---------------|------------------|----------------------|----------------------|
| 1 | EWG | L = 520 - 550 B = 350 - 380 D/H = 390 - 425 | | 01 | 02 | 02 | 03 |
| 2 | WALL MOUNTED WASH HAND BASIN | L = 450 - 475 B = 350 - 375 D/H = 195 - 210 | | 01 | 03 | 03 | 05 |
| 3 | SS TOWEL RAIL | MIN 20MM DIA, 400 LONG, 1.5MM THICK | | --- | --- | 02 | 03 |
| 4 | TOWEL RING | RING DIA-150MM ROD DIA - MIN 8MM | | 01 | 03 | 03 | 05 |
| 5 | SS TOWEL RACK (WALL MOUNTED) | L = 600 B = 250 | | 01 | 02 | --- | --- |
| 6 | OVERHEAD RAIN SHOWER SQUARE WITH 200 LONG ARM 125 MM Ø FOR OFFR'S | 200 X 200 MM | | 01 | 02 | --- | --- |
| 7 | OVERHEAD SHOWER WITH 200 MM LONG SHOWER ARM AND WALL FLANGE | 125 MM DIA | | --- | --- | 02 | 03 |
| 8 | HEALTH FAUCET WITH TAP (1 MTR LONG HOSE PIPE WITH SELF CLEANING NOZZLE) | | | 01 | 02 | 02 | 03 |
| 9 | 8MM TH GLASS SHELF WITH 50 HT SS RAILING FIXED TO WALL AT 1200 HT FROM FFL (IN OFFRS TOILET) | 225 X 225 | | 01 | 02 | --- | --- |
| 10 | 25MM TH POLISHED MARBLE SHELF FIXED TO WALL AT 1200 HT FROM FFL | 225 X 225 | | --- | --- | 02 | 03 |
| 11 | SS PEG SET OF THREE | 200 X 38 X 38 MM (MIN.) | | 01 | 02 | 02 | 03 |
| 12 | MIRROR OF THICKNESS 6MM | 750 X 600 MM (MIN.) | | 01 | 02 | --- | --- |
| 13 | MIRROR OF THICKNESS 6MM | 450 X 600 MM (MIN.) | | --- | --- | 03 | 05 |
| 14 | SS SOAP TRAY | 125 X 115 MM (MIN.) | | 01 | 03 | --- | --- |
| 15 | CHROMIUM PLATED SOAP DISH | 125 X 115 MM (MIN.) | | --- | --- | 03 | 05 |
| 16 | PVC TOILET CABINET | 300 X 150 X 450 MM (MIN.) | | 01 | 02 | --- | --- |
| 17 | URINAL (315 X 265 X 440 MM) SHORT | L = 315 - 350 B = 250 - 275 D/H = 440 - 460 | | --- | 03 | 03 | 04 |
| 18 | URINAL PARTITION (90 X 320 X 720 MM) | L = 690 - 720 B = 320 - 340 D/H = 90 - 165 | | --- | 03 | 03 | 03 |

NOTE - 1. IN CASE OF ANY MISMATCH BETWEEN THIS TABLE AND DETAILS SHOWN IN PLAN OF TOILETS, DETAILS SHOWN IN THIS TABLE SHALL BE FOLLOWED.

| SL NO | DATE | DESCRIPTION | INITIAL |
|---|-------------|---|-------------------|
| REVISIONS | | | |
| PROVN OF HANGAR AND ANNEXE BUILDING AT INS DEGA VISAKHAPATNAM | | | |
| HANGAR AND ANNEXE BUILDING | | | |
| STAIR CASE, TOILETS AND OTHER DETAILS | | | |
| DATE | 28 FEB 2023 | CHIEF ENGINEER (NAVY) VISAKHAPATNAM ZONE | SHEET NO 8R/13 |
| DRN | S B SAHOO | | |
| TOC | | | |
| OKD | | | |
| SCALE | 1:150 | REF DRG NO : CEVZ / 2022 / WD - 2120 | |
| AAD (ARCH) | | JT DIR (ARCH) | |
| DIRECTOR (ARCH) FOR CHIEF ENGINEER | | | |